

**EXHIBIT "B"**

**ANNEXATION BOUNDARY MAP**

**BOUNDARY MAP  
COMMUNITY FACILITIES DISTRICT NO. 2011-01  
(CONGESTION MANAGEMENT)  
OF THE CITY OF SAN MARCOS  
ANNEXATION NO. 12  
EXHIBIT "B"**



1 inch = 50 feet

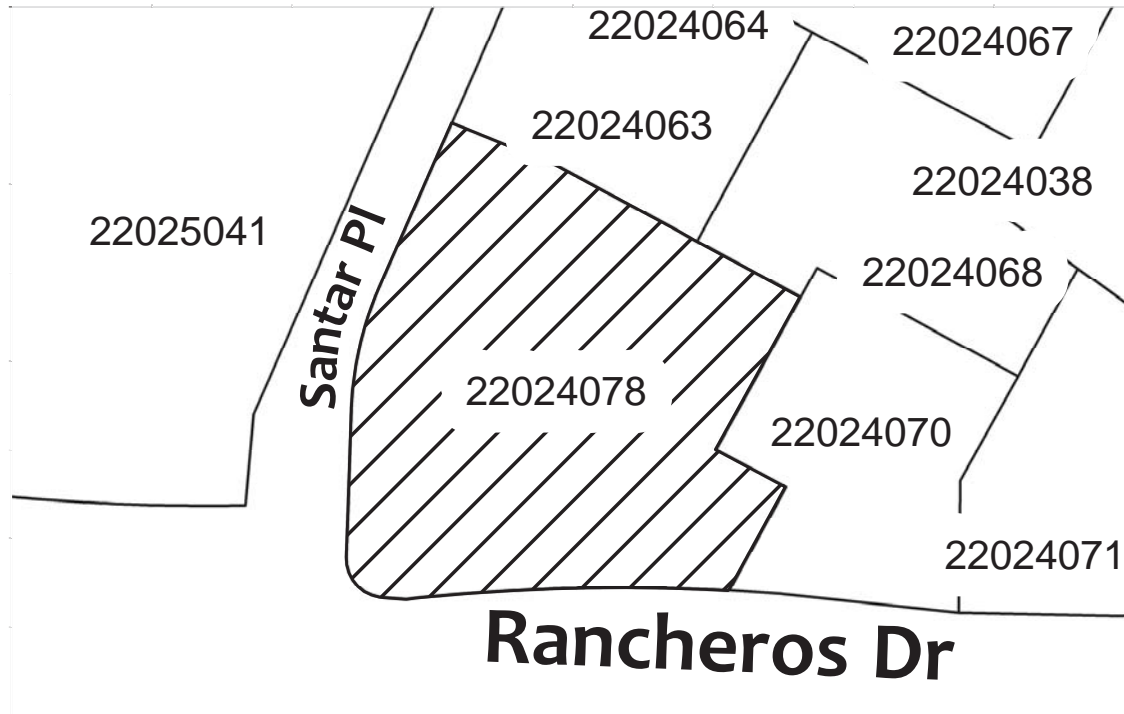

FILED IN THE OFFICE OF THE CITY CLERK THIS \_\_\_\_\_ DAY OF \_\_\_\_\_  
2017.

\_\_\_\_\_  
PHILLIP SCOLLYCK  
CITY CLERK  
CITY OF SAN MARCOS, STATE OF CALIFORNIA

I HERBY CERTIFY THAT THE MAP SHOWING BOUNDARIES AND TERRITORIES TO BE  
ANNEXED TO COMMUNITY FACILITIES DISTRICT 2011-01 (CONGESTION MANAGEMENT),  
CITY OF SAN MARCOS, COUNTY OF SAN DIEGO, STATE OF CALIFORNIA,  
WAS APPROVED BY THE CITY COUNCIL OF THE CITY OF SAN MARCOS AT A REGULAR MEETING  
THEREOF HELD ON THE 11TH DAY OF JULY, 2017 BY ITS RESOLUTION NO. 2017-\_\_\_\_\_.

\_\_\_\_\_  
PHILLIP SCOLLYCK  
CITY CLERK  
CITY OF SAN MARCOS, STATE OF CALIFORNIA

FILE NO. 2017-\_\_\_\_\_

FILED THIS \_\_\_\_\_ DAY OF \_\_\_\_\_, 2017 AT \_\_\_\_\_  
O'CLOCK IN BOOK \_\_\_\_\_, PAGE \_\_\_\_\_ OF MAPS OF ASSESSMENT AND COMMUNITY  
DISTRICTS IN THE OFFICE OF THE COUNTY RECORDER OF THE COUNTY OF SAN DIEGO,  
STATE OF CALIFORNIA.

ERNEST J. DRONENBURG JR.,  
COUNTY RECORDER

BY: DEPUTY COUNTY RECORDER

**Legend**

 ANNEXATION BOUNDARY

CITY OF SAN MARCOS

SHEET 1 OF 1